

Basement Floor Plan

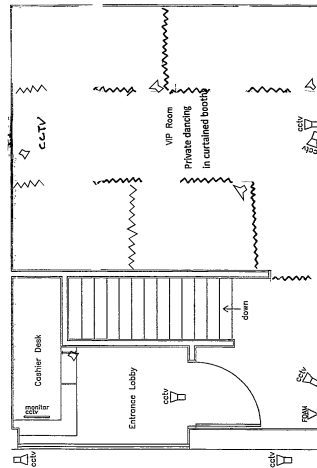

Ground Floor Plan

~~~~~ - Curbin

- E1, 23/09/2019 relocated shower and additional CCTV cameras
- D, 03/05/16 remove music control booth and add CCTV cameras
- C, February 2016 - new dance area 3
- B, 01/05/2015 - relocate stage

A, 25.3.15 CCTV, stage, Curbins  
Rev. No. Date Description

|                                                                                                                                                                                                                     |                   |
|---------------------------------------------------------------------------------------------------------------------------------------------------------------------------------------------------------------------|-------------------|
|                                                                                                                                                                                                                     |                   |
| Project:<br>Southchurch Road<br>Southend-on-Sea<br>Essex<br>Items:                                                                                                                                                  | <b>Floor Plan</b> |
| Scale: 1:50 - of A0<br>Drawing No: 14-1606-01                                                                                                                                                                       | Date: 18/09/2019  |
| <small>NOTE: Dimensions to be checked on site before any commences<br/>         in any area this drawing, work only to specified dimensions<br/>         Report of discrepancies to the Principal Engineer.</small> |                   |

**SEVICENCE PLAN**  
 Loose furniture is shown for diagrammatic purposes  
 only. Fire fighting equipment is shown at the date hereof and may be moved by agreement with the fire authority.  
 Dated 18.09.2019